

Mixing units, wash down and hoses station

16350 blv. Gouin Ouest, Ste-Geneviève, Québec H9H 1E1

Toll free : 1-800-624-4709 (514)624-4772 Fax : 624-4776

Email : info@charlandthermojet.com Web: www.charlandthermojet.com

P1 CLAMPING TOOL

PUNCH-LOCK CLAMPING TOOL

The original. Made like no other tool ! Designed for fast, economical application of punch-type clamps. The portable P-1 weighs only 2-1/2 pounds. Drop forged and double plated tempered steel construction. This tool can be used for clamp from 1" to 8" and more.

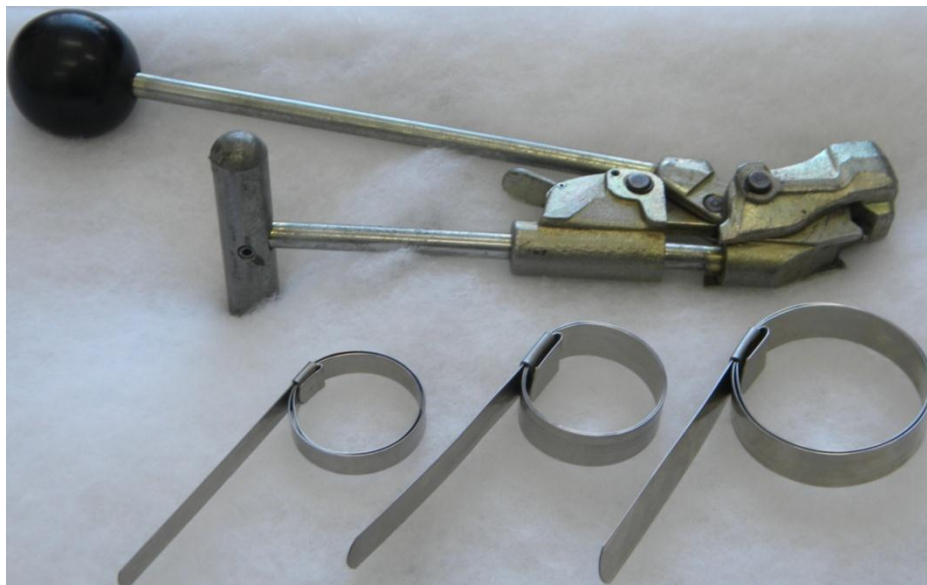
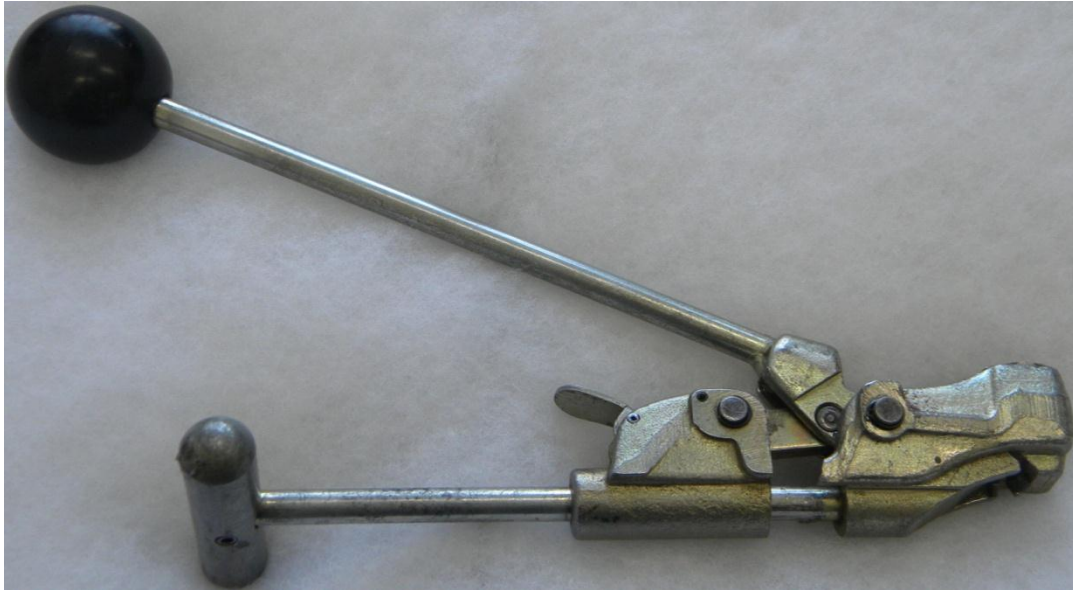

Mixing units, wash down and hoses station

16350 blv. Gouin Ouest, Ste-Geneviève, Québec H9H 1E1

Toll free : 1-800-624-4709 (514)624-4772 Fax : 624-4776

Email : info@charlandthermojet.com Web: www.charlandthermojet.com

REPLACEMENT PARTS FOR P1 CLAMPING TOOL

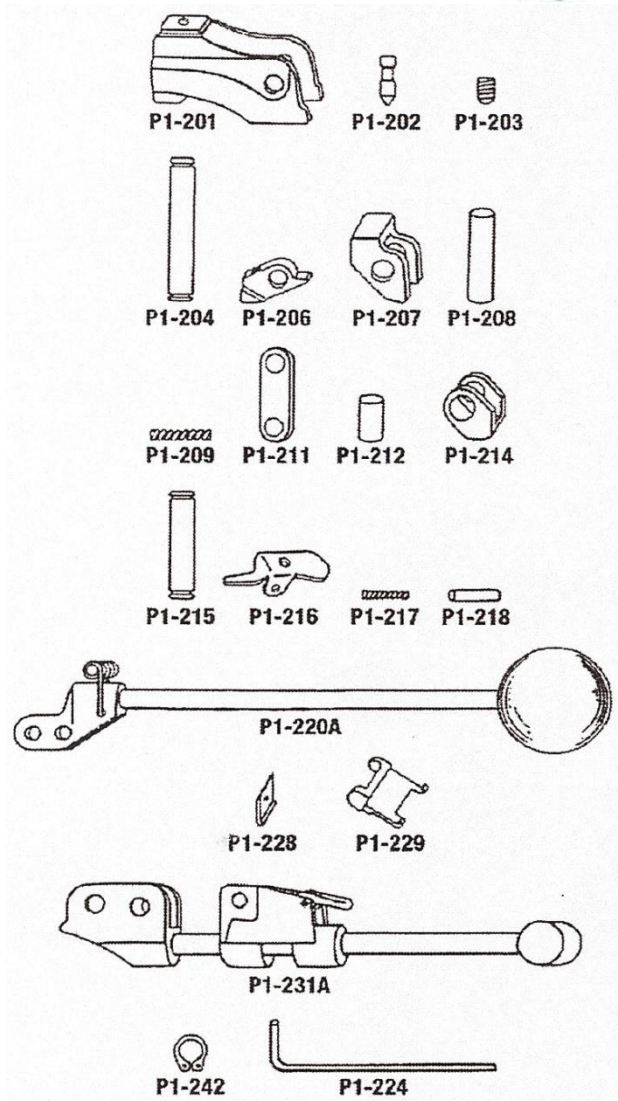

PART NUMBER	DESCRIPTION
P1-201	Punch head
P1-202	Punch
P1-203	Set screw
P1-204	Punch head pin
P1-206	Pusher nose
P1-207	Holding dog
P1-208	Pusher nose pin
P1-209	Holding dog spring
P1-211	Puller link
P1-212	Puller link pin
P1-214	Pulling dog
P1-215	Pulling dog pin
P1-216	Release lever
P1-217	Pulling dog spring
P1-218	Release lever pin
P1-220A	Ball handle assy
P1-224	Proximity pin
P1-225A	Mallet
P1-228	Formed washer
P1-229	3/8" Clamp adapter
P1-231A	Push/pull assy
P1-242	Retaining rings

Mixing units, wash down and hoses station

16350 blv. Gouin Ouest, Ste-Geneviève, Québec H9H 1E1

Toll free : 1-800-624-4709 (514)624-4772 Fax : 624-4776

Email : info@charlandthermojet.com Web: www.charlandthermojet.com

ALL STAINLESS STEEL CLAMP

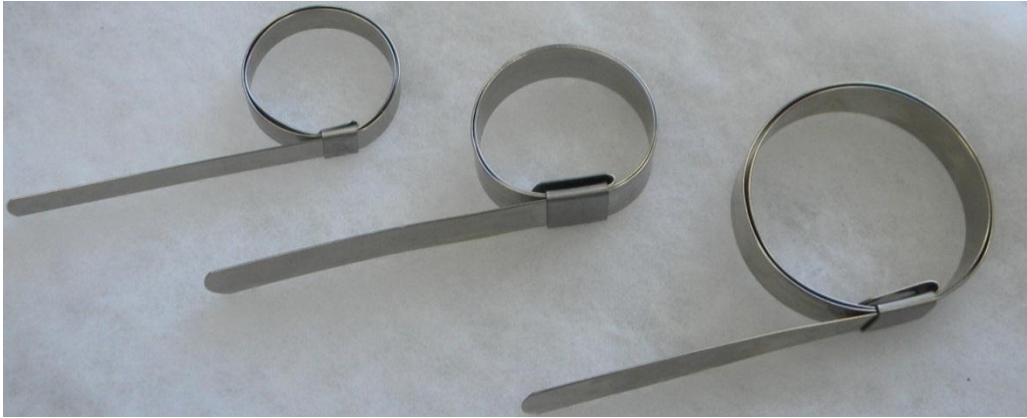

5/8" (16 mm) width

INSIDE DIAMETER	STANDARD PKG	PART NUMBER
1" (25.4 mm)	100	CPS-04
1-1/4" (32 mm)	100	CPS-05
1-1/2" (38 mm)	100	CPS-06
1-3/4" (44.5 mm)	100	CPS-07
2" (51 mm)	100	CPS-08
2-1/4" (57 mm)	100	CPS-09
2-1/2" (63.5 mm)	50	CPS-10
2-3/4" (70 mm)	50	CPS-11
3" (76 mm)	50	CPS-12
3-1/2" (89 mm)	50	CPS-14
4" (102 mm)	25	CPS-16
4-1/2" (114 mm)	25	CPS-18
5" (127 mm)	25	CPS-20
6" (152 mm)	25	CPS-24
7" (178 mm)	25	CPS-28
8" (203 mm)	25	CPS-32

3/8" (10 mm) width

INSIDE DIAMETER	STANDARD PKG	PART NUMBER
1-3/8" (35 mm)	100	CPS-311
2" (51 mm)	100	CPS-316

For more information or any questions please contact us.